

## Manual Tool Changer – OnRobot



#8225  
Robot-Side



#8221  
EOAT-Side

The Robot-Side Tool Changer is fully collaborative with no sharp edges, which makes it easy and safe for human interaction. The Tool Changer can handle up to a 44 lbs (20kg) payload and has a low built-in height and weight.

Compatible with eSeries UR, and any other cobot that uses the ISO 9409-1-50-4-M6 mounting pattern and can be easily adapted to even more robots.

Built into every OnRobot gripper, the EOAT-Side Tool Changer is now available for all EOAT which makes it easy to click into your cobot. With a 20kg max. payload, this quick changer is a simple way to swap your EOAT in between applications.

Use with pneumatic grippers, degating kits, or any third-party product compatible with ISO 9409-1-50-4-M6 bolt pattern.

Quick#	Part#	Description	Weight	Price
8225	OR-QC-A1*	Robot-Side	58.9g	\$588.00
8221	OR-102014	EOAT-Side	140g	\$588.00

\*Not compatible with CB3 series UR.

8224	OR-102326	Robot-Side for CB Series	95.2g (0.21lb)	\$700.00
------	-----------	--------------------------	----------------	----------

OnRobot pricing effective 05/01/24 and subject to change.

Technical Specs	
Maximum permissible force	400 N (89.9 lbf)
Maximum permissible torque	50 Nm (442 in-lb)
Rated payload	20kg (44 lbs)
Repeatability	+/- 0.02mm

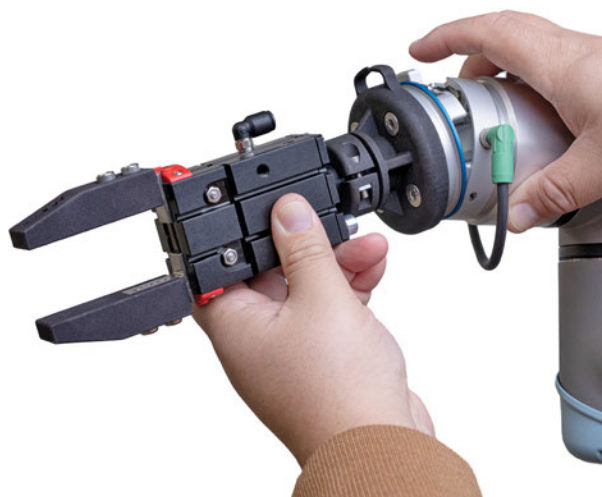

Example of Q#8221 with a customized pneumatic gripper solution.

### M8 8-Pin Tool Flange Connection for UR & Fanuc CRX



#8230

Quick#	Part#	Description	Price
8230	OR-102113*	M8 8-Pin Female Tool Flange for UR	\$95.00
8237	OR-107456**	M8 8-Pin Female Tool Flange for Fanuc CRX	\$95.00
8239	OR-113690	Cable Kit for ABB Gofa to Robot Wrist I/O	\$409.00

\*Required to use Quick #8220/8225 Tool Changer on eSeries UR and Quick #8224 Tool Changer on previous (CB3) UR models to connect directly to the Tool I/O M8 connector.

\*\*Required to use Quick# 8220/8225 on Fanuc CRX Tool I/O M8 connector.

(Dimensioned drawings shown full scale)

**Robot-Side**

- #8225 & #8224: M8 8-Pin Female Tool Flange Connection Q#8230 required for UR Robot.  
M8 8-Pin Male Tool Flange Connection Q#8237 required for Fanuc CRX Robot.
- #8225 & #8224: Have the same dimensions except for the overall height as noted below.

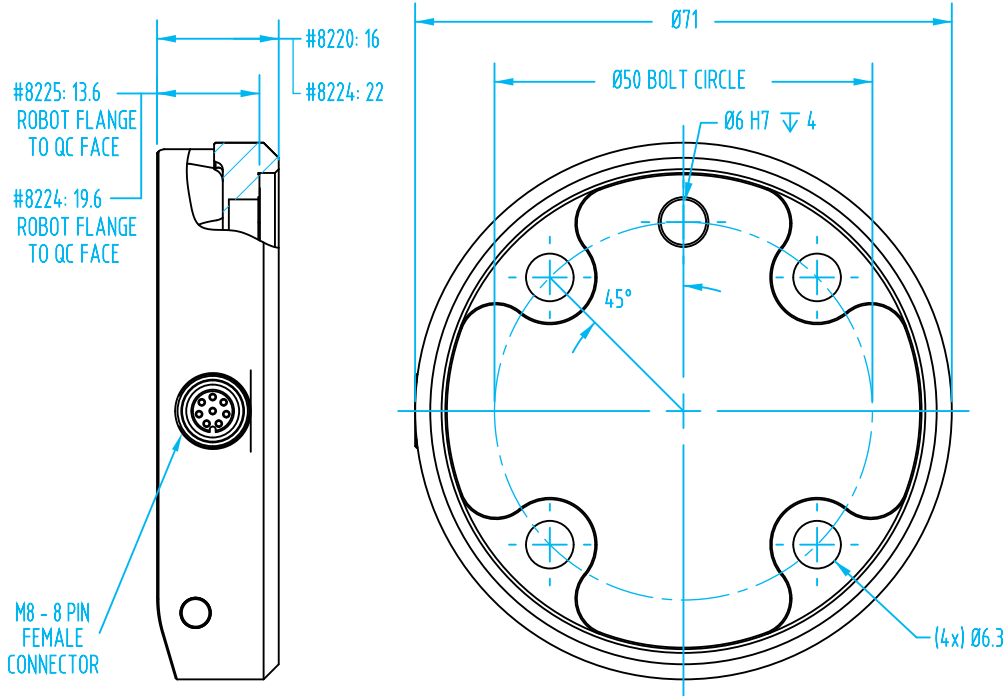

#8225  
Robot-Side, 4.5a compatible



#8224  
Robot-Side, for CB Series UR  
Not compatible with eSeries UR

- CU
- QC
- VG
- VC
- VA
- SG
- GR
- MT
- AC
- CS
- CC

**EOAT-Side**

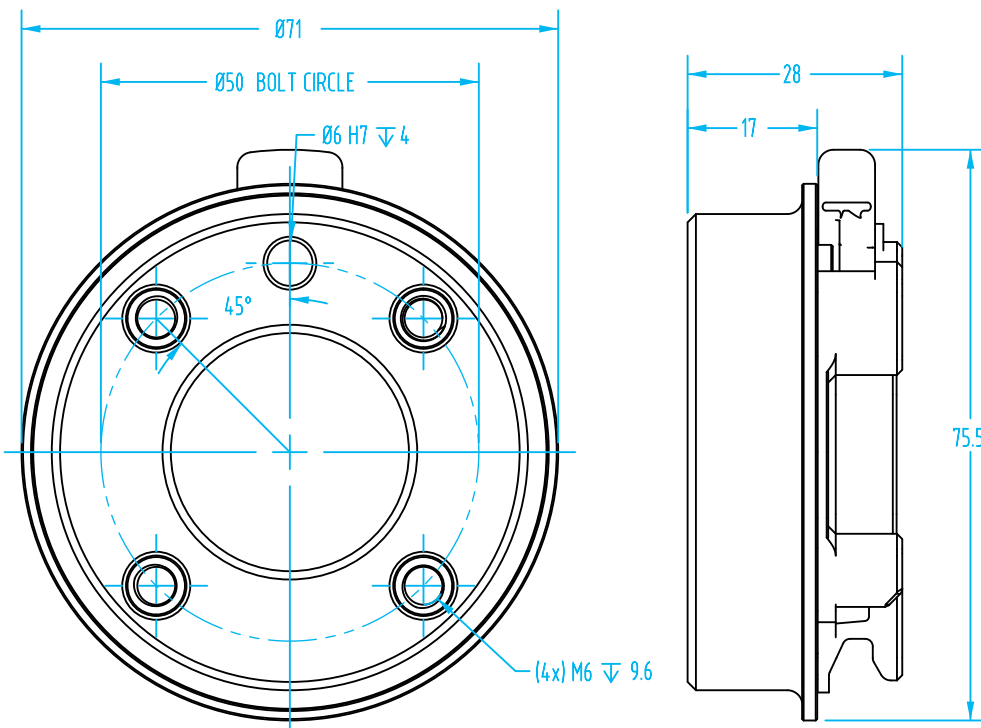

#8221  
EOAT-Side